

## TAPP ME Android (Worker & Supervisor) - Bug #9502

Home Screen --> Login with New worker --> Update password --> need to show validation below input field if Password should be 8-16 characters along with Alphanumeric with special character

03/27/2024 03:44 PM - Shivangi Bhargava

<b>Status:</b>	Closed	<b>Start date:</b>	03/27/2024
<b>Priority:</b>	Normal	<b>Due date:</b>	
<b>Assignee:</b>	Nasim Ansari	<b>% Done:</b>	0%
<b>Category:</b>		<b>Estimated time:</b>	0.00 hour
<b>Target version:</b>		<b>Spent time:</b>	0.00 hour

### Description

Issue description:

need to show validation below input field if Password should be 8-16 characters along with Alphanumeric with special character

See attached screenshot:

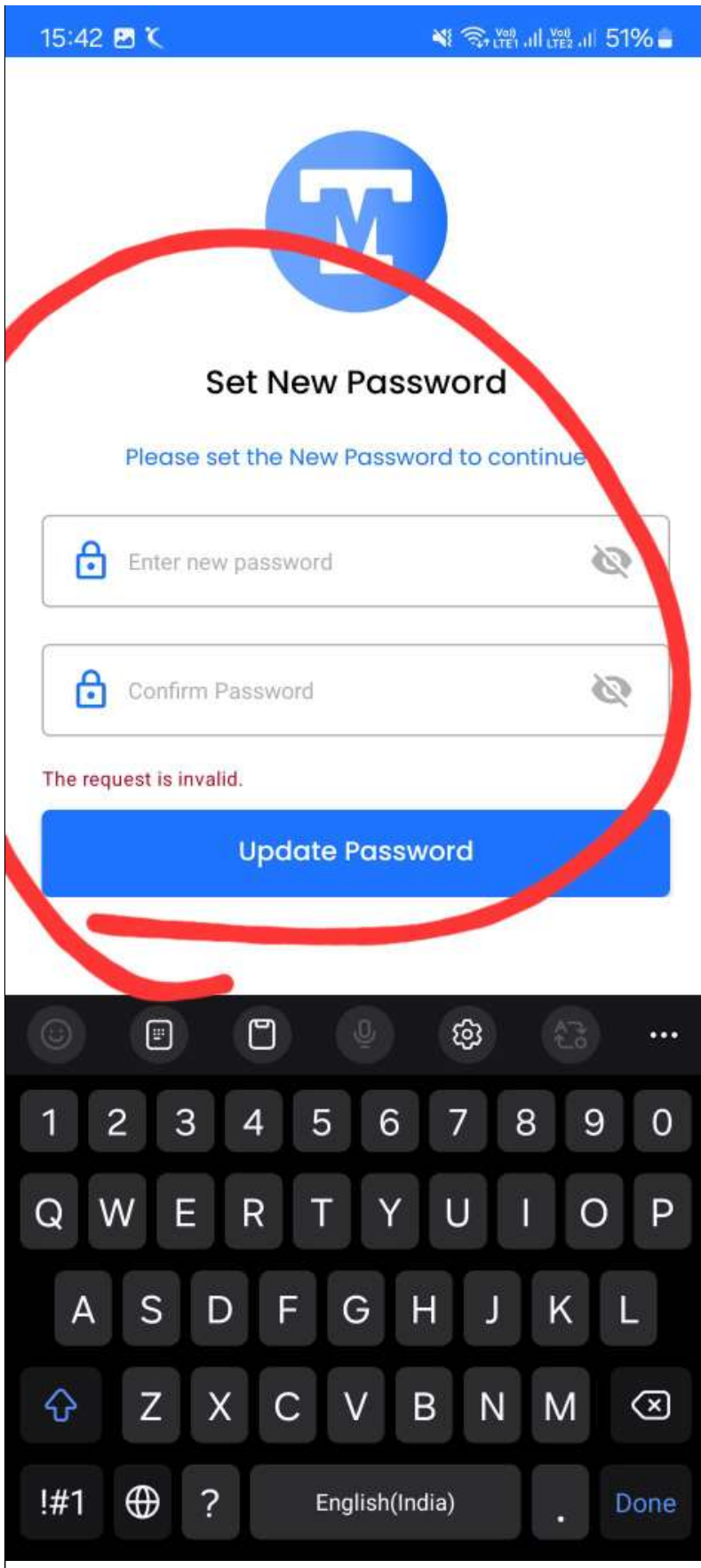

### History

#1 - 04/03/2024 11:12 AM - Nasim Ansari

- Status changed from New to Resolved

#2 - 04/03/2024 05:06 PM - Mohd Irfan

- File clipboard-202404031705-rnhcu.png added

- Status changed from Resolved to Closed

Fixed!



## Change Password

Please set the New Password to continue

Enter old password

Old password is required.

Enter new password

Password should be 8 to 15 characters including Capital Letters, Small Letters, Special Characters, & Numbers

Confirm Password

Password should be 8 to 15 characters including Capital Letters, Small Letters, Special Characters, & Numbers

The request is invalid.

Change Password



**Files**

---

clipboard-202403271542-skrcm.png	255 KB	03/27/2024	Shivangi Bhargava
clipboard-202404031705-rnhcu.png	415 KB	04/03/2024	Mohd Irfan